



200KG CAPACITY

SUITABLE FOR:
CLASSIC AND ROD HAMMOCKS FROM **280cm** TO **380cm(L)**

UNIVERSAL HAMMOCK STAND

LIST OF PARTS

A	Metal arm pipe with fixed hooks, 42mm DIA x 910mm	2
B	Male extension pipes, 36mm DIA x 640mm	2
C	End angle tube (wheels included on one part)	2
D	Centre base extension pipe, 36mm DIA x 840mm	1
E	Metal stand pipe, 40mm DIA x 980mm	2
F	Plastic stand feet	4
G	Plastic inside collar	4
H	Plastic external collar	6
I	Tri-wing hand screws	14

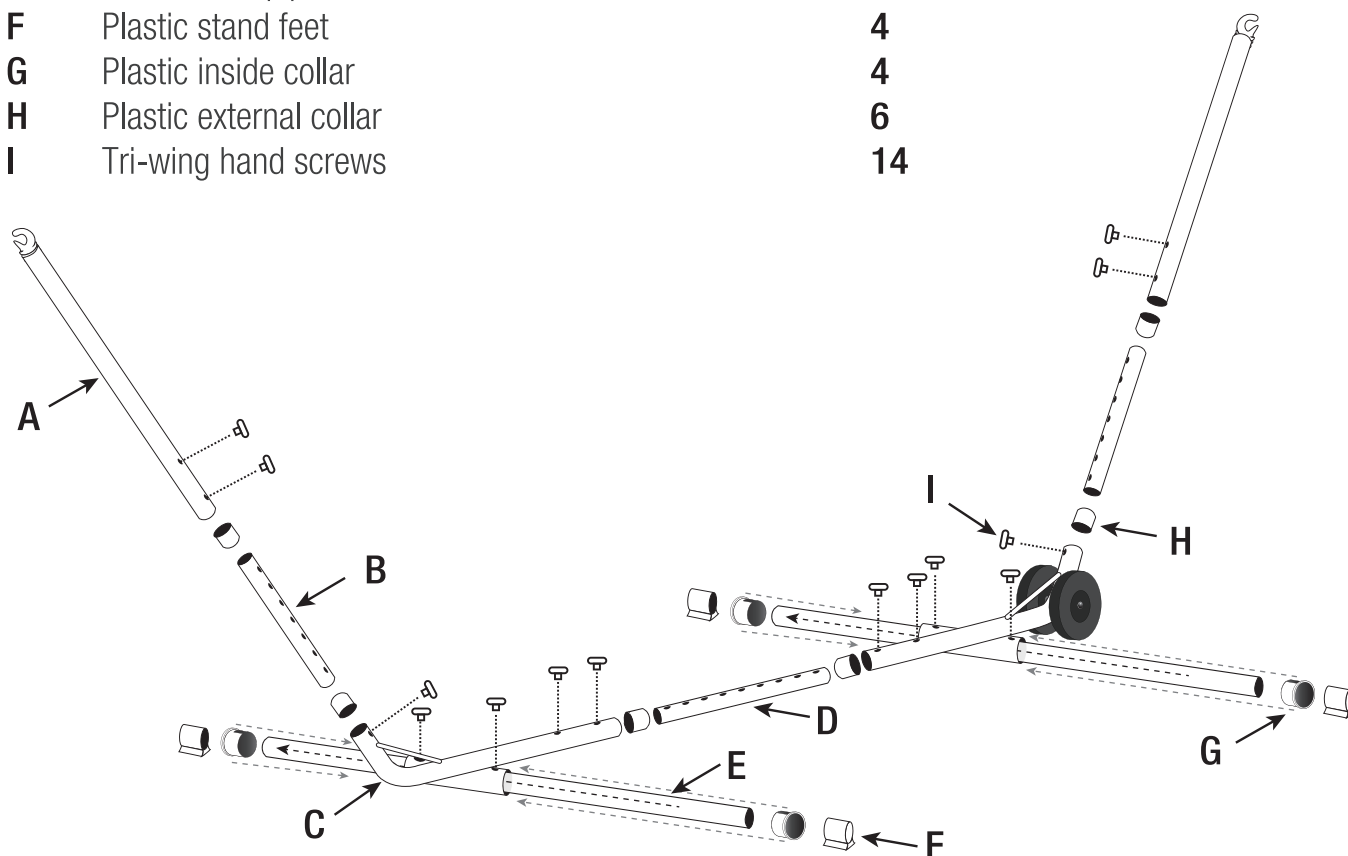

HAMMOCK STAND MIN SIZE:
295cm (L) x 100cm (W) x 105cm (H)
Suitable for hammocks with a minimum of
280cm from end to end



HAMMOCK STAND MAX SIZE:
380cm (L) x 100cm (W) x 132cm (H)
Suitable for hammocks with a maximum of
380cm from end to end

SAFETY INSTRUCTIONS

1. Do not exceed the maximum load.
2. Do not climb into hammock feet first.
3. Do not dive into or jump about in hammock.
4. Do not stick your head through the end strings.
5. Keep end strings as straight as possible, do not twist.
6. Do not use damaged or weakened hammock hanging accessories.
7. Hammocks are not designed for swinging.
8. Assembly should always be carried out by an adult.
9. Do not leave children unattended in hammock or near hammock.
10. Hammock fabrics and accessories will wear over time and use. Always check the loading capacity and condition of parts before use.
11. If possible, only use the hammock on floors with shock-absorbing properties such as carpet or outdoor grass to minimise the risk of injury in case of falling out of the hammock.



200KG CAPACITY

SUITABLE FOR:
CLASSIC AND ROD HAMMOCKS FROM **280cm** TO **380cm**(L)

UNIVERSAL HAMMOCK STAND

ASSEMBLY INSTRUCTIONS

1. Connect item **C** with metal stand pipes **E**. Place inside collars **G** on either side of the end angle tube **C** and secure with tri-wing hand screws **I**. Repeat at the other end.

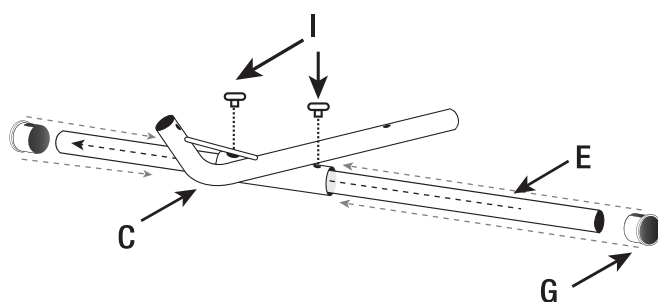

2. Take the centre base extension pipe **D** and join both end angle tubes **C** together. Be sure to insert external collars **H** on either side of the centre extension pipe **D**. Four screws **I** will be needed to fix this in place.

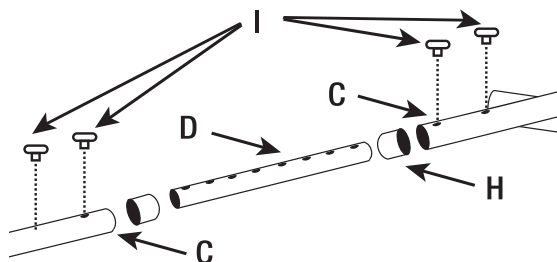

3. Attach one male extension pipe **B** on top of each end angle tube **C**. Be sure to use an external collar **H** in between pipes. One screw **I** on each side will be needed to fix this into place.

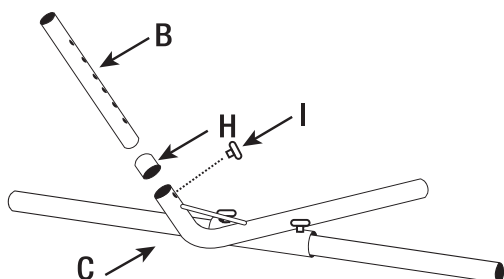

4. Connect the metal arm pipes **A** to the male extension pipes **B**. Place external collars **H** when connecting the metal arm pipe **A** to the male extension pipe **B**. Two screws **I** will be needed to fix this in place.
The metal arm pipes **A** can sit at varying heights. Adjust the height so that the hammock does not touch the ground when in use.

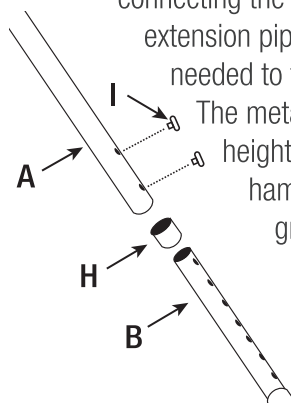

5. Take the plastic stand feet **F** and insert to each end of the metal stand pipes **E**.

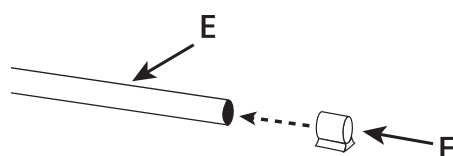

Now you are ready to hang your hammock onto the hooks.

Note: Adjust the length and height of your stand to suit your hammock by extending or shortening the fixtures on Parts **D** and **B**.

Made in China exclusively for
Mayo Hardware Pty Ltd
4 Secombe Place, Moorebank
NSW 2170 Australia
Customer Service Phone:
1300 360 211
www.mayohardware.com.au | 2017©

For more information visit
www.twotreeshammocks.com.au

We will honour all statutory guarantees
that this product is of acceptable quality.
(including that it is fit for purpose)